

Alle Maßangaben in mm, Gewicht ca. kg pro 100 Stk.
all sizes in mm, weight approx. in kg per 100 pcs

REMA Lipprandt GmbH & Co KG
Homepage: <http://www.rema-bonn.de>

REMA

Optische und technische Änderungen vorbehalten
We reserve the right to carry out optical and technical changes

Telephone/Telefon: ++49/2 28/3 82 04-0
Telecopy/Telefax: ++49/2 28/3 82 04 45
e-mail: sales@rema-bonn.de

CU

Freileitungsklemmen ohne Steg

- ▶ Werkstoff: E-Cu DIN 40500
- ▶ Oberfläche: blankgebeizt
- ▶ Schrauben: DIN 84 / DIN 933 Bronze , F 60
- ▶ Mutter: DIN 934 / Kupfer

Copper tap-off clamps for overhead lines without pressure pad

- ▶ Material: E-Cu DIN 40500
- ▶ Surface: bright
- ▶ Screws: DIN 84 / DIN 933 bronze , F 60
- ▶ Nut: DIN 934 / copper

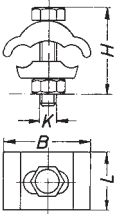
mit Bronzeschrauben
with bronzescrews

mm ² sqmm	L	B	H	K	Gewicht weight	Kat. Nr. cat.-no.
2,5 - 16	16	19,5		M5	2,10	25210 - 00
2,5 - 25	18	25,0		M6	4,10	25220 - 00
2,5 - 25	20	25,0		M7	3,95	25230 - 00
6 - 35	20	28,0		M7	6,00	25240 - 00
6 - 50	24	32,5		M7	8,00	25250 - 00
6 - 50	22	33,5		M8	8,60	25260 - 00
6 - 70	24	37,5		M8	11,10	25270 - 00
10 - 95	28	41,0		M8	15,60	25280 - 00

mit Bronzeschrauben
with bronzescrews

mm ² sqmm	L	A	B	H	K	Gewicht weight	Kat. Nr. cat.-no.
2,5 - 16	24,0	13,0	20,5	16	M5	3,70	25350 - 00
2,5 - 25	27,0	13,5	25,5	21	M6	6,40	25360 - 00
* 2,5 - 25	30,0	15,0	25,0	22	M7	7,70	25370 - 00
6 - 35	30,0	15,0	30,0	23	M7	8,50	25380 - 00
6 - 50	32,0	16,0	33,0	26	M7	12,30	25390 - 00
* 10 - 50	36,0	18,0	32,5	27	M8	12,90	25400 - 00
6 - 70	38,0	19,0	37,0	29	M8	18,10	25410 - 00
* 10 - 95	46,0	25,5	45,0	36	M10	28,70	25420 - 00
* 16 - 150	52,0	26,0	52,5	40	M10	37,40	25430 - 00

* Beim Einklemmen von zwei Seilen mit dem gleichen, für die Klemmen zulässigen Höchstquerschnitt sind 2 Abzweigklemmen oder spezielle Stromklemmen anzuwenden

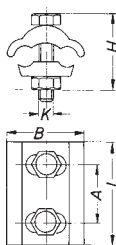

Alle Maßangaben in mm, Gewicht ca. kg pro 100 Stk.
all sizes in mm, weight approx. in kg per 100 pcs

CU

Freileitungsklemmen mit Steg

- ▶ Werkstoff: E-Cu DIN 40500
- ▶ Oberfläche: blankgebeizt
- ▶ Schrauben: DIN 84 / DIN 933 Bronze , F 60
- ▶ Mutter: DIN 934 / Kupfer

Copper tap-off clamps for overhead lines with pressure pad

- ▶ Material: E-Cu DIN 40500
- ▶ Surface: bright
- ▶ Screws: DIN 84 / DIN 933 Bronze , F 60
- ▶ Nut: DIN 934 / copper

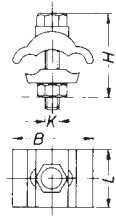
mit Bronzeschrauben
with bronzescrews

mm ² sqmm	L	B	H	K	Gewicht weight	Kat. Nr. cat.-no.
2,5 - 16	16	19,5	16	M5	2,60	25500 - 00
2,5 - 25	18	25,0	21	M6	4,30	25510 - 00
2,5 - 25	18	25,0	22	M7	4,60	25520 - 00
6 - 35	20	28,0	23	M7	6,30	25530 - 00
6 - 50	20	32,5	26	M7	7,90	25540 - 00
6 - 50	22	33,5	27	M8	9,10	25550 - 00
6 - 70	24	37,0	29	M8	11,60	25560 - 00
10 - 95	31	45,0	36	M10	19,60	25570 - 00

mit Bronzeschrauben
with bronzescrews

mm ² sqmm	L	A	B	H	K	Gewicht weight	Kat. Nr. cat.-no.
2,5 - 16	24,0	13,0	19,5		M5	4,10	25650 - 00
2,5 - 25	27,0	14,0	25,5		M6	7,00	25660 - 00
2,5 - 25	30,0	15,0	25,0		M7	7,90	25670 - 00
6 - 35	32,0	16,0	28,0		M7	10,20	25680 - 00
6 - 50	32,0	17,0	33,0		M7	12,80	25690 - 00
10 - 50	34,5	18,0	32,5		M8	14,70	25700 - 00
6 - 70	38,5	19,0	37,0		M8	19,10	25710 - 00
10 - 95	43,0	20,0	41,0		M8	25,00	25720 - 00
16 - 150	52,0	26,0	52,5		M10	39,00	25730 - 00

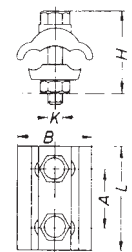

Alle Maßangaben in mm, Gewicht ca. kg pro 100 Stk.
all sizes in mm, weight approx. in kg per 100 pcs

MS**Freileitungsklemmen ohne Steg**

- ▶ Werkstoff: Cu Zn 40 Pb 2 DIN 17660
- ▶ Oberfläche: verzinkt
- ▶ Schrauben: DIN 84 / DIN 933 Stahl, verzinkt
- ▶ Mutter: DIN 934 / Stahl, verzinkt

Brass tap-off clamps for overhead lines without pressure pad

- ▶ Material: Cu Zn 40 Pb 2 DIN 17660
- ▶ Surface: tinned
- ▶ Screws: DIN 84 / DIN 933 steel, tinned
- ▶ Nut: DIN 934 / steel, tinned

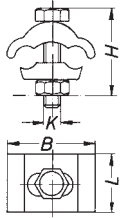
**mit Stahlschrauben
with steelscrews**

mm ² sqmm	L	B	H	K	Gewicht weight	Kat. Nr. cat.-no.
2,5 - 16	16	20,0		M5	1,90	26000 - 00
4 - 16	16	19,5		M5	2,00	26010 - 00
6 - 25	20	25,0		M6	3,70	26020 - 00
10 - 50	24	34,0		M7	7,30	26040 - 00
25 - 95	31	46,0		M10	17,10	26060 - 00

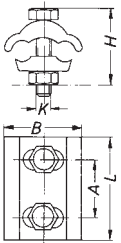
**mit Stahlschrauben
with steelscrews**

mm ² sqmm	L	A	B	H	K	Gewicht weight	Kat. Nr. cat.-no.
2,5 - 16	22	12,0	19,5		M5	3,05	26150 - 00
6 - 25	26	13,5	25,0		M6	5,40	26160 - 00
6 - 35	30	15,0	29,0		M7	7,60	26170 - 00
10 - 50	34	18,0	34,0		M7	10,80	26180 - 00
25 - 95	46	26,0	45,0		M10	28,00	26200 - 00

Alle Maßangaben in mm, Gewicht ca. kg pro 100 Stk.
all sizes in mm, weight approx. in kg per 100 pcs

MS

Freileitungsklemmen ohne Steg

- ▶ Werkstoff: Cu Zn 40 Pb 2 DIN 17660
- ▶ Oberfläche: verzinkt
- ▶ Schrauben: DIN 84 / 933 / Bronze F 60
- ▶ Mutter: DIN 934 / Kupfer

Brass tap-off clamps for overhead lines without pressure pad

- ▶ Material: Cu Zn 40 Pb 2 DIN 17660
- ▶ Surface: tinned
- ▶ Screws: DIN 84 / 933 / Bronze F 60
- ▶ Nut: DIN 934 / copper

mit Bronzeschrauben
with bronze screws

mm ² sqmm	L	B	H	K	Gewicht weight	Kat. Nr. cat.-no.
2,5 - 16	16	20,0		M5	2,00	26300 - 00
4 - 16	16	20,0		M5	2,00	26310 - 00
6 - 25	25	25,0		M6	4,20	26320 - 00
10 - 50	24	34,0		M7	7,60	26340 - 00

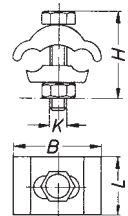
mit Bronzeschrauben
with bronze screws

mm ² sqmm	L	A	B	H	K	Gewicht weight	Kat. Nr. cat.-no.
4 - 16	22	12,0	20,0		M5	3,20	26450 - 00
6 - 25	26	15,0	25,0		M6	5,40	26460 - 00
10 - 50	34	18,0	34,0		M7	10,80	26480 - 00
25 - 95	48	26,0	46,0		M10	28,00	26500 - 00

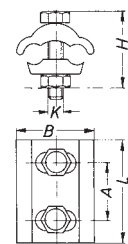

Alle Maßangaben in mm, Gewicht ca. kg pro 100 Stk.
all sizes in mm, weight approx. in kg per 100 pcs

AL**Freileitungsklemmen mit Steg**

für Aluminium- und Al-dreiseile nach DIN 48201
und Aluminium/Stahlseile nach DIN 48204

- ▶ Werkstoff: AL Mg Si 1 DIN 1725
- ▶ Oberfläche: blankgebeizt
- ▶ Schrauben: DIN 933 Stahl, feuerverzinkt
- ▶ Mutter: DIN 934 Stahl, feuerverzinkt

Aluminium tap-off clamps for overhead lines with pressure pad

for tap-off connection of Al-, Al-alloy conductors acc. to 48201
and ACSR conductors acc. To DIN 48204

- ▶ Material: AL Mg Si 1 DIN 1725
- ▶ Surface: bright
- ▶ Screws: DIN 933 steel, hot-dipped galvanized
- ▶ Nut: DIN 934 steel, hot-dipped galvanized

mm ² sqmm	Seil Ø	L		B	H	K	Gewicht weight	Kat. Nr. cat.-no.
16-50	5,1- 9,0	45		33,3	40	2 x M8	10,00	26610-00
16-70	5,1- 10,5	49		37,0	40	2 x M8	10,70	26620-00
16-95	5,1- 12,5	55		41,7	45	2 x M8	13,30	26630-00
16-120	5,1- 14,0	55		44,8	50	2 x M8	16,10	26635-00
25-150	6,3- 15,7	61		52,0	50	2 x M10	22,20	26640-00
35-185	6,3- 17,5	65		57,0	60	2 x M10	29,40	26650-00
35-240	7,5- 20,2	70		64,6	70	2 x M10	39,20	26660-00

alternativ mit Spannscheibe
alternativ with spring washers

AL**Freileitungsklemmen mit Steg**

- ▶ Werkstoff: AL Mg Si 1 DIN 1725
- ▶ Oberfläche: blankgebeizt
- ▶ Schrauben: DIN 933 Stahl, feuerverzinkt
- ▶ Mutter: DIN 934 Stahl, feuerverzinkt

Aluminium tap-off clamps for overhead lines with pressure pad

- ▶ Material: AL Mg Si 1 DIN 1725
- ▶ Surface: bright
- ▶ Screws: DIN 933 steel, hot-dipped galvanized
- ▶ Nut: DIN 934 steel, hot-dipped galvanized

mm ² sqmm	Seil Ø	L		B	H	K	Gewicht weight	Kat. Nr. cat.-no.
16-50	5,1- 9,0	68		33,3	40	3 x M8	13,50	26695-00
16-70	5,1- 10,5	74		37,0	40	3 x M8	16,40	26700-00
16-95	5,1- 12,5	83		41,7	45	3 x M8	22,20	26710-00
16-120	5,1- 14,0	83		44,8	50	3 x M8	24,40	26715-00
25-150	6,3- 15,7	92		52,0	50	3 x M10	34,00	26720-00
35-185	6,3- 17,5	98		57,0	60	3 x M10	44,10	26725-00
35-240	7,5- 20,2	105		64,6	70	3 x M10	52,50	26730-00

alternativ mit Spannscheibe
alternativ with spring washers

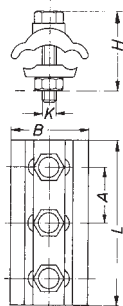
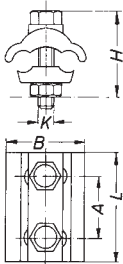

Alle Maßangaben in mm, Gewicht ca. kg pro 100 Stk.
all sizes in mm, weight approx. in kg per 100 pcs

Nachrüstbare REMA Kunststoffabreißschraube

Diese Entwicklung aus dem Hause REMA ist derzeit in zwei Größen erhältlich*

SW 13 (M8) 16 NM (+/- 2 NM Toleranz)
 SW 17 (M17) 22 NM (+/- 2 NM Toleranz)

*weitere auf Kundenwunsch realisierbar.

Ihre Funktion bleibt innerhalb der Temperaturwerten von -20 ° bis +50° voll erhalten. Der obere Teil der Kunststoffschraube dient zum Anziehen der Schraube, der untere zum Lösen.

Alle Aluminium- und Kunststoff- Klemmen aus dem Hause REMA, sind direkt mit diesen Schrauben lieferbar. Der Kunststoffkopf ist natürlich auch nachrüstbar für alle Klemmen die mit Schrauben nach DIN 933 bestückt sind. Die Montage erfolgt ohne Sonderwerkzeug.

Die wesentlichen Vorteile sind:

- ▶ ständig gleichbleibende Montage
- ▶ bei AL Klemmen kein Zerstören der Gewinde
- ▶ bei Kunststoff - Klemmen keine Überbeanspruchung des Kunststoffes
- ▶ Leiter erhalten gute elektrische Leitfähigkeit; damit garantierte Wärmeausdehnungsfähigkeit
- ▶ Nachrüstbar für Schrauben nach DIN 933
- ▶ Kein teurer Drehmomentschlüssel notwendig
- ▶ Umweltverträglich da recyclingfähig

REMA plastic shear-off-head

Until now, this development of REMA is available in two sizes*:

*Solutions and further sizes upon customer request.

We guarantee the full function of the shear-off-head for temperatures between -20° and +50°. The upper part is used to tighten the screw, the lower to release it.

All REMA AL and plastic clamps can be delivered with the plastic shear-off-head. Of course it also possible to retrofit all clamp version which are equipped with DIN 933 screws.

Basic advantages of the plastic share off head are :

- ▶ Easy to assemble
- ▶ The head will always shear-off at the required torque moment
- ▶ Continuous pressure on the clamp
- ▶ Easy release by hexagon socket
- ▶ No destruction of the screws thread while using Al clamps
- ▶ No overloading of the plastic while using plastic clamps
- ▶ optimal electrical conductivity and guaranteed thermal expansion
- ▶ Retrofitable for screws acc. to DIN 933
- ▶ no torque wrench required
- ▶ enviromental compatibility as recyclable



AL

Universal Freileitungsklemmen

Endbund-, Stromschlaufen-, Beiseil- und Abweikklemme

- ▶ Werkstoff: AL Mg Si 1 DIN 1725
- ▶ Oberfläche: blankgebeizt
- ▶ Schrauben: DIN 933 Stahl, feuerverzinkt
- ▶ Mutter: DIN 934 Stahl, feuerverzinkt
- ▶ Federringe: DIN 934 Stahl, DIN 127 Federstahl, feuerverzinkt

Aluminium universal clamps for overhead lines

- ▶ Material: AL Mg Si 1 DIN 1725
- ▶ Surface: bright
- ▶ Screws: DIN 933 steel, hot-dipped galvanized
- ▶ Nut: DIN 934 steel, hot-dipped galvanized
- ▶ Spring washers: DIN 127 / spring steel, hot-dipped galvanized

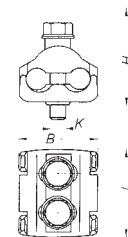

mm ² sqmm		Ausführung type	L	B	H	K	Gewicht weight	Kat. Nr. cat.-no.
Hauptleiter main conductor								
Al	Al/St							
16 - 70	16/2,5 - 70/12	blankgebeizt verzinkt *	46	40	42	M8	10,50	27930 - 00 27940 - 00

Alle Maßangaben in mm, Gewicht ca. kg pro 100 Stk.
 all sizes in mm, weight approx. in kg per 100 pcs

AL/CU

Abzweigklemmen

- ▶ Werkstoff: AL Mg Si 1 DIN 1725
E-Cu DIN 40500
- ▶ Oberfläche: blankgebeizt
- ▶ Schrauben: DIN 603 Stahl, feuerverzinkt
- ▶ Mutter: DIN 603 Stahl, feuerverzinkt
- ▶ Federplatten: DIN 17004 / Federstahl, DIN 4310 (Nirosta)

Tap-off clamps

- ▶ Material: AL Mg Si 1 DIN 1725
E-Cu DIN 40500
- ▶ Surface: bright
- ▶ Screws: DIN 603 steel, hot-dipped galvanized
- ▶ Nut: DIN 603 steel, hot-dipped galvanized
- ▶ Spring washers: DIN 17004 / spring steel, DIN 4310 (Nirosta)

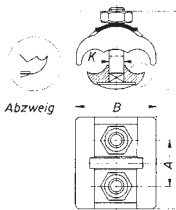
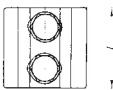
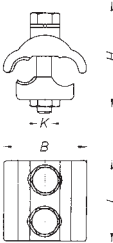
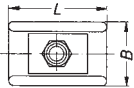
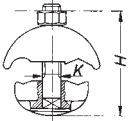

Abzweig

mit einer Schraube / with one bolt							
mm ² / sqmm		L	B	H	Gewicht weight	Kat. Nr. ohne Steg cat.-no. without com. pad	Kat. Nr. mit Steg cat.-no. with com. pad
AL Hauptleiter AL main conductor	CU Abzweig CU tap-off						
16-70	6-25	39,5	26,0		0,075	28410-00	
16-95	1,5-35	39,5	26,0		0,066	28400-00	
16-70	6-50	39,5	26,0		0,067	28415-00	
35-120	10-50	43,0	30,0		0,081	28420-00	

mit zwei Schrauben / with two bolts							
mm ² / sqmm		L	B	H	Gewicht weight	Kat. Nr. ohne Steg cat.-no. without com. pad	Kat. Nr. mit Steg cat.-no. with com. pad
AL Hauptleiter AL main conductor	CU Abzweig CU tap-off						
16-95	1,5-35				0,105		27900-00
25-95	6-50	40,0	39,5		0,110		27910-00
16-70	6-50	40,0	39,5		0,107		27915-00
35-120	10-50	44,0	43,0		0,134		27905-00
25-150	10-95	48,0	47,7		0,155		27910-00
95-240	10-50	48,0	44,0		0,150		27911-00
35-200	16-185	64,0	58,0		0,306		27912-00

mit drei Schrauben / with three bolts							
mm ² / sqmm		L	B	H	Gewicht weight	Kat. Nr. ohne Steg cat.-no. without com. pad	Kat. Nr. mit Steg cat.-no. with com. pad
AL Hauptleiter AL main conductor	CU Abzweig CU tap-off						
125-150	10-95	64,0	48,0		0,215		27924-00
35-185	35-185	97,0	58,0		0,482		27925-00
35-300	35-240	105,0	66,0		0,592		27926-00

Alle Maßangaben in mm, Gewicht ca. kg pro 100 Stk.
all sizes in mm, weight approx. in kg per 100 pcs

T-Abzweigklemmen

- ▶ Werkstoff: CuZn 40 Pb 2 DIN 17660
- ▶ Oberfläche: verzinkt
- ▶ Schrauben: DIN 603 Stahl, verzinkt

T-Tap-off clamps

- ▶ Material: CuZn 40 Pb 2 DIN 17660
- ▶ Surface: tinned
- ▶ Screws: DIN 603 steel, galvanized

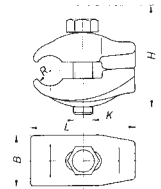

mm ² sqmm		L	B	R	H	K	Gewicht weight	Kat. Nr. cat.-no.
Hauptleiter main conductor	Abzweig tap-off							
16 - 50	4 - 25	32	15,0	4,50	34	M6	5,20	31150 - 00
35 - 70	6 - 50	39	17,5	5,25		M8	8,70	31160 - 00
70 - 120	16 - 70	46	19,5	7,50		M8	12,40	31170 - 00
16 - 50	4 - 25	32	15,0	4,50	34	M6 *	5,60	31200 - 00
35 - 70	6 - 50	39	17,5	5,25		M8 *	9,30	31210 - 00
70 - 120	16 - 70	46	19,5	7,50		M8 **	13,20	31220 - 00

mit Tellerfeder * bzw. Federdruckplatte ** (zum Schwundausgleich)

Schlitzbolzenklemmen

- ▶ Werkstoff: E-Cu DIN 40500
- ▶ Oberfläche: blankgebeizt

Copper split bolts

- ▶ Material: E-Cu DIN 40500
- ▶ Surface: bright

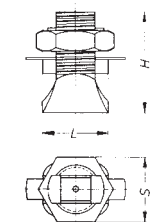

Querschnitt sqmm		L	S	H	Gewicht weight	Kat.Nr. cat.-no.
Hauptleiter main conductor	Abzweig tap-off					
2,5 - 10	2,5 - 10	13,5	13	26	1,45	79100 - 00
4,0 - 16	2,5 - 16	17,0	17	28	2,30	79110 - 00
6,0 - 25	4,0 - 25	21,0	19	35	3,95	79120 - 00
10,0 - 35	4,0 - 35	23,0	22	42	6,05	79130 - 00
16,0 - 50	4,0 - 50	26,0	24	45	7,35	79140 - 00
25,0 - 70	4,0 - 70	28,0	27	44	9,60	79150 - 00
35,0 - 95	6,0 - 95	32,0	32	52	14,70	79160 - 00
50,0 - 120	6,0 - 120	36,0	36	56	19,30	79170 - 00
70,0 - 150	6,0 - 150	38,0	38	60	24,70	79180 - 00

Alle Maßangaben in mm, Gewicht ca. kg pro 100 Stk.
all sizes in mm, weight approx. in kg per 100 pcs

Hängeklemme für Kathodenabfalleiter



CU

- ▶ Werkstoff: E-Cu DIN 40500
- ▶ Oberfläche: blankgebeizt
- ▶ Schrauben: DIN 933 Bronze
- ▶ Zahnscheibe: DIN 6797 Bronze

AL

- ▶ Werkstoff: Al Mg Si 1 DIN 1725
- ▶ Oberfläche: blankgebeizt
- ▶ Schrauben: DIN 933 Stahl, feuerverzinkt
- ▶ Federscheibe: DIN 137
- ▶ Schrauben: DIN 933/V2 a
- ▶ Tellerfedern: DIN 2093/V2 a

AL/CU

- ▶ Werkstoff: Al/Cu
- ▶ Oberfläche: blankgebeizt
- ▶ Übergang: Al/Cu mit Lack versiegelt
- ▶ Schrauben: DIN 933 Stahl, feuerverzinkt
- ▶ Federscheibe: DIN 137

Suspension grip for cathode fall arrester



CU

- ▶ Material: E-Cu DIN 40500
- ▶ Surface: bright
- ▶ Screws: DIN 933 Bronze
- ▶ Lock washer: DIN 6797 bronze

AL

- ▶ Material: E-Cu DIN 40500
- ▶ Surface: bright
- ▶ Screws: DIN 933 Bronze
- ▶ Lock washer: DIN 6797 bronze

AL/CU

- ▶ Material: Al/Cu
- ▶ Surface: bright
- ▶ Transition: Al/Cu varnished
- ▶ Screws: DIN 933 bronze, hot-dipped galvanized
- ▶ Spring washer: DIN 137



CU

mm ² sqmm	L	A	B	E	H	K		Gewicht weight	Kat. Nr. cat.-no.
6 - 70 16 - 120	15 13	30 32	33 40	M8	45	M6		8,60 11,30	29600 - 00 29610 - 00

AL

16 - 120	21	32	40	M8	55	M6	Stahl V 2 a	4,80	29800 - 00 29810 - 00
----------	----	----	----	----	----	----	----------------	------	--------------------------

AL/CU

16 - 120	21	32	40	M8	55	M6	V 2 a	7,50	29850 - 00
----------	----	----	----	----	----	----	-------	------	------------

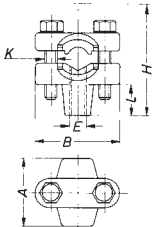

Alle Maßangaben in mm, Gewicht ca. kg pro 100 Stk.
all sizes in mm, weight approx. in kg per 100 pcs

Schraub-Verbindungsklemme

- ▶ Werkstoff: Al Mg Si 1 DIN 1725
- ▶ Oberfläche: blankgebeizt
- ▶ Schrauben: Gewindestifte mit Innensechskant und Kuppe, Messing, verziert

Straight connector

- ▶ Material: Al Mg Si 1 DIN 1725
- ▶ Surface: bright
- ▶ Screws: headless pin with inner hexagonal, brass, tinned



QMM	L	D	d	Schrauben screws	INBUS MIT SW	Kat. Nr. cat.-no.
6- 25qmm RE/SE/RM/SM	40	16	9,3	2 Madenschrauben M 8 x 1	SW4	31740-02
25- 70qmm SM/SE 95qmm SE(4) 25- 95qmm RM	55	25	14	2 Madenschrauben M 12 x 1	SW5	31750-02
16- 50qmm RE 35-150qmm RE/SE/SM 185qmm SM 35-185qmm RM	80	35	21	2 Madenschrauben M 18 x 1,5	SW6	31760-02

Isolierte Abzweigklemmen für isolierte Leiter

- ▶ Werkstoff: Glasfaserverstärkter Kunststoff & hochfeste Kupferlegierung
- ▶ Schrauben: Feuerverzinkter Stahl
- ▶ Muttern: Feuerverzinkter Stahl
- ▶ Druckstücke: Feuerverzinkter Stahl

Fully insulated tap-off clamps for insulated lines

- ▶ Material: glass-fibre reinforced plastic & copper alloy
- ▶ Screws: hot-dipped galvanized steel
- ▶ Nuts: hot-dipped galvanized steel
- ▶ Plates: hot-dipped galvanized steel

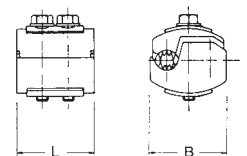

Hauptleiter mm ² main conductor sqmm	Abzweig mm ² tap-off conductor	Anzahl Schrauben number of bolts	Länge mm length mm	Breite mm width mm	Gewicht weight	Kat. Nr. cat.-no.
16 - 25	1,5 - 2,5	1	20	34	5,8	21990 - 00
5 - 70	6,0 - 35	1	33	38	12,0	22000 - 00
25 - 95	10,0 - 50	2	54	52	27,0	22030 - 00
50 - 120	10,0 - 95	2	54	56	28,0	22040 - 00

Alle Maßangaben in mm, Gewicht ca. kg pro 100 Stk.
all sizes in mm, weight approx. in kg per 100 pcs

Fahnenanschluss-Aufsatzklemme

- ▶ Werkstoff: Cu Zn 40 Pb 2 DIN 17660
- ▶ Oberfläche: verzinkt
- ▶ Schrauben: DIN 933 Stahl, verzinkt
- ▶ Mutter: DIN 934 Stahl
- ▶ Tellerfedern: DIN 2093

Connection terminals

- ▶ Material: Cu Zn 40 Pb 2 DIN 17660
- ▶ Surface: tinned
- ▶ Screws: DIN 933 steel, galvanized
- ▶ Nuts: DIN 934 steel
- ▶ Buffer washers: DIN 2093

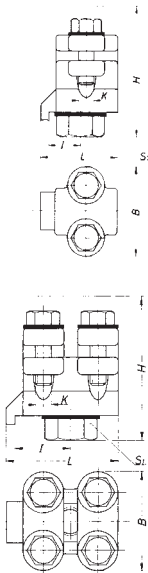

mm ² sqmm	L	B	I	H	K	Bodenschraube S1 bottom screw	Gewicht weight	Kat. Nr. cat.-no.
6 - 35	19	28,0	10,0	35	M5	M8 x 10	5,30	32000 - 00
25 - 70	25	34,0	10,0	35	M6	M8 x 10	8,60	32010 - 00
		12,5	40,0			M10 x 12	9,80	32020 - 00
35 - 120	31	36,0	12,5	46		M10 x 15	13,50	32030 - 00
		15,0	46,0			M10 x 15	13,50	32040 - 00
		15,0	48,0			M12 x 15	15,40	32050 - 00
		17,0	46,0			M10 x 15	13,50	32060 - 00
		17,0	48,0			M12 x 15	15,40	32070 - 00
35 - 150	30	46,0	15,0	51	M8	M12 x 15	20,60	32090 - 00
		15,0	56,0			M12 x 20	21,00	32100 - 00
		17,0	51,0			M12 x 15	20,60	32110 - 00
95 - 185	33		15,0	60		M12 x 15	22,30	32120 - 00
			65,0			M12 x 20	22,70	32130 - 00
120 - 240	44	52	20	60	M8	M12 x 20	50,00	32200 - 00
							M16 x 20	55,00

Endbündelklemme

mit ausgemittelter Rillenführung (nur für Endbünde verwendbar)

CU

- ▶ Werkstoff: Cu Ni Si
- ▶ Oberfläche: blankgebeizt
- ▶ Schrauben: DIN 933 Bronze, F60
- ▶ Muttern: DIN 934 Kupfer

AL

- ▶ Werkstoff: Al Mg Si 1 DIN 1725
- ▶ Oberfläche: blankgebeizt
- ▶ Schrauben: DIN 933 Stahl, feuerverzinkt
- ▶ Muttern: DIN 934 Stahl

Deadend clamps (block type)

CU

- ▶ Material: Cu Ni Si
- ▶ Surface: bright
- ▶ Screws: DIN 933 bronze, F60
- ▶ Nuts: DIN 934 copper

AL

- ▶ Material: Al Mg Si 1 DIN 1725
- ▶ Surface: bright
- ▶ Screws: DIN 933 steel, hot-dipped galvanized
- ▶ Nuts: DIN 934 steel, hot-dipped galvanized

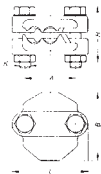

mm ² sqmm			L		B	H	K	Gewicht weight	Kat. Nr. cat.-no.
Cu	Al	Al/St							
10 - 16			36	22	35	25	M7	10,30	27600 - 00
25 - 35			47	30	47	30	M8	18,40	27610 - 00
50 - 70			59	39	59	40	M10	39,50	27620 - 00

AL

25 - 35	25/4 - 35/6	47	30	47	30	M8	8,50	27710 - 00
50 - 70	50/8 - 70/12	59	39	59	40	M10	18,50	27720 - 00
95 - 120	95/15	78	52	70	55	M12	35,70	27730 - 00

Alle Maßangaben in mm, Gewicht ca. kg pro 100 Stk.
all sizes in mm, weight approx. in kg per 100 pcs

AL**Aufsatzklemmen für Direktanschluss**

- ▶ Werkstoff: Hochfeste Al-Legierung (AlMgSi), korrosionsbeständig
- ▶ Oberfläche: verzinkt
- ▶ Schraube: Stahl Güte 8.8 feuerverzinkt
- ▶ Spannscheibe: Federstahl mechanisch verzinkt, kugelplattiert

Connection terminals

- ▶ Material: High strength A-alloy (AlMgSi), corrosion-resistant
- ▶ Surface: tinned
- ▶ Scew: Steel 8.8 hot dip galvanized
- ▶ Belleville spring: Spring steel, electro galvanized

sm	se	rm	re	a	b	c	Schraube screw	Gewicht/100kg weight	Kat.-Nr.: cat.-no.
35- 50	50- 70	10-35	16-50	25	19	21	M 8x40	3,7	
35- 50	50- 70	10-35	16-50	28	21	24	M 10x45	5,9	
35- 50	50- 70	10-35	16-50	29	23	19	M 10x45	6,0	
35- 50	50- 70	10-35	16-50	29	23	19	M 10x45	7,7	
25- 150	35- 185	35-70	50	38	27	30	M 10x45	8,0	
25- 150	35- 185	35-70	50	38	27	30	M 12x55	9,8	
35- 50	50- 185	35-70	50	35	26	29	M 12x55	8,3	
35- 150	50- 185	35-70	50	35	26	29	M 12x55	10,1	
120- 240	150- 300			45	32	40	M 12x65	17,1	

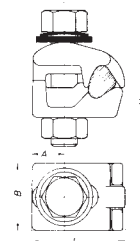
**MS****Aufsatzklemmen für Direktanschluss**

- ▶ Werkstoff: Messing (CuZn)
- ▶ Oberfläche: verzinkt
- ▶ Schraube: Stahl Güte 8.8 feuerverzinkt
- ▶ Spannscheibe: Federstahl mechanisch verzinkt, kugelplattiert

Connection terminals

- ▶ Material: Brass (CuZn)
- ▶ Surface: tinned
- ▶ Scew: Steel 8.8 hot dip galvanized
- ▶ Belleville spring: Spring steel, electro galvanized

sm	se	rm	re	a	b	c	Schraube screw	Gewicht/100kg weight	Kat.-Nr.: cat.-no.
35- 50	50- 70	10-35	16-50	25	18	21	M 8x40	6,5	
35- 50	50- 70	10-35	16-50	28	21	24	M 10x45	10,5	
35- 50	50- 70	10-35	16-50	29	23	19	M 10x45	11,0	
35- 50	50- 70	10-35	16-50	29	23	19	M 12x45	12,6	
35- 150	50- 185	35-70	50	35	26	29	M 10x55	16,1	
35- 150	50- 185	35-70	50	35	26	29	M 12x55	17,7	
120- 240	150- 300			45	32	40	M 12x65	38,5	

Alle Maßangaben in mm, Gewicht ca. kg pro 100 Stk.
all sizes in mm, weight approx. in kg per 100 pcs